



## **LIGHT KIT (LED) MD & MT P/N 7989-14**

**DESCRIPTION:** This light kit is designed to be used with models D and T, and is now compatible with HI-Dump™ units.

### **INSTRUCTIONS:**

1. Raise the tractor body and remove the plastic dome plugs from the body as shown in the illustrated parts breakdown.
2. Slide the two (2) grommets (P/N 5977-1) over the ends of the power lead wire assembly (P/N 7995-7) and route the ends of the power lead wire up through the body as shown in the illustrated parts breakdown. With the power lead wire in place, insert the grommets into the body.
3. Push the two (2) wire saddles (P/N 7834-2) into the holes shown in the illustrated parts breakdown. If the holes shown are not present, mark the two locations using the dimensions shown in illustration "A" and drill using a 5/32" bit. Insert the power lead wire into the wire saddles and route the power lead wire through the hole in the forward speed control mount bracket as shown in the illustrated parts breakdown.
4. The power lead wire will plug into auxiliary power which is located on the right side of the battery as shown in the illustrated parts breakdown. Determine the length required and cut the power lead wire to length. Strip 1/4" of insulation from the wire and crimp the bullet connector (P/N 5996-4) to the wire. Plug the wire into the auxiliary power and secure the power lead wire using the included cable ties (P/N 5975-3) where shown in the illustrated parts breakdown.
5. Fasten the light bar (P/N 7993-7) to the tractor using the light bar doublers (P/N 7993-2) on the underside of the body as shown in the illustrated parts breakdown. Plug the power lead wire into the light assemblies (P/N 7989-5) as shown. Close the tractor body, turn the key to the ON/RUN position and test the lights for proper operation using the toggle switch located on the instrument panel.

ITEM NO.	PART NO.	DESCRIPTION	QTY REQ'D
1	7989-5	Light Assembly (LED)	2
2	5996-13	16-14 GA Ring Term. (#10) Insulated	2
3	5996-4	16-14 GA Bullet Connector (M) Insulated	2
4	5996-5	16-14 GA Bullet Connector (F)	*
5	7993-7	Mount Bracket, Lights	1
6	7993-5	Headlight Plate, LH	1
7	7993-6	Headlight Plate, RH	1
8	7432	Shock Mount (1.0 OD x .75)	4
9	7995-7	Light Kit Wire Assembly (Includes Items #3, 4, & 12)	1
10	5975-1	Cable Tie (18# x 3-3/4")	3
11	7993-2	Light Bar Doubler	2
12	5977-1	Grommet (1/8 x 3/8)	2
13	5833	Cable Clamp (1/4)	4
14	5975-3	Cable Tie (50# x 7")	2
15	7834-2	Wire Saddle (2 Wires)	2
16	5977-9	Grommet	2
F002	F002	10-24 Keps Nut	4
F004	F004	1/4-20 Keps Nut	8
F009	F009	5/16-18 Whiz Locknut	2
F026	F026	10-24 x 1/2 PPHMS	4
F226	F226	5/16-18 x 7/8 Hex Bolt	2
F316	F316	5/16-18 x 1-3/4 Hex Bolt	2
F551	F551	5/16-18 Flange Top Lock Nut	2

| A

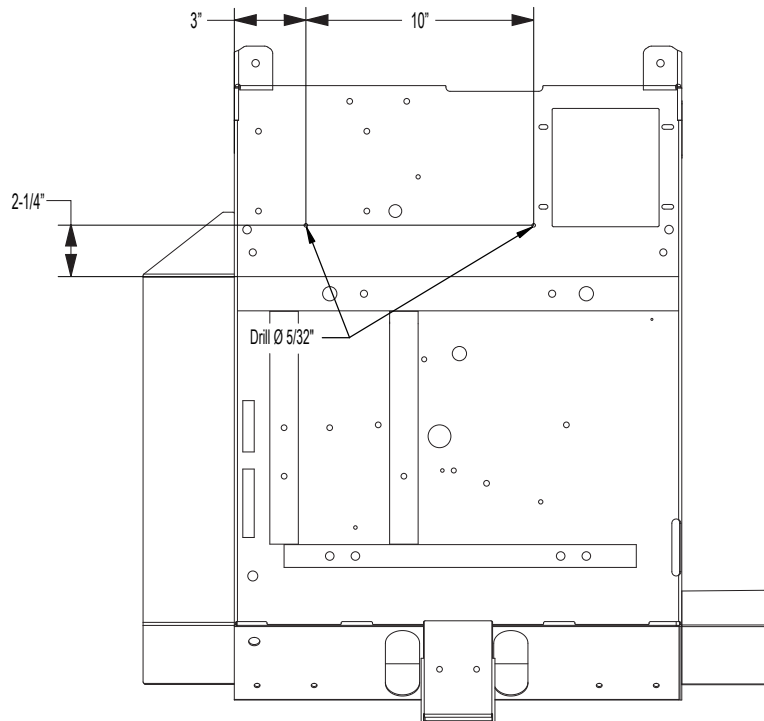
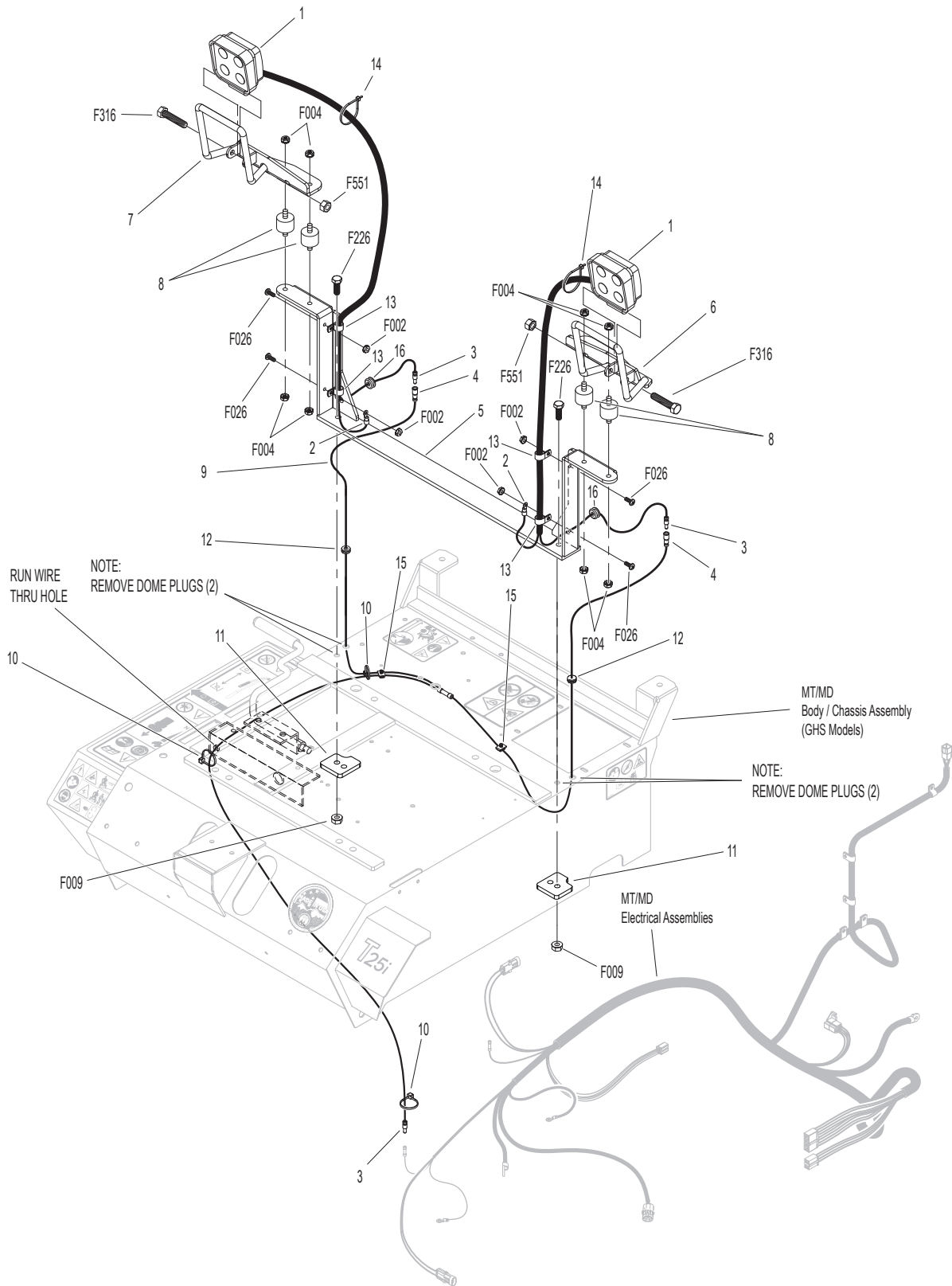

Illustration "A"



Illustrated Parts Breakdown