

SCAG POWER EQUIPMENT

SERVICE INFORMATION SHEET 109

Cutter Deck Belt Routing & Pulley Height Chart

The following chart will assist you in the proper repair of Scag equipment. Use these tables as a reference when servicing or repairing the cutter deck belt or pulleys on any Scag machine with a serial number of 8910001 or higher.



Cutter Deck Belt Routing & Pulley Height Chart

** All measurements are from the end of the shaft to the top of the Tapered Hub or Pulley

All References for Left, Right or Center are from the Operator's position

Turf Tiger (STT & STTII) Cutter Deck Belt Routing		Spindle Pulley Alignment		Deck Size	Ref	Right Spindle	Center Spindle	Left Spindle
		Hub	"A"	52"	"A"	** 1.19"	** 1.19"	** 1.19"
		Pulley		61"	"A"	** 1.19"	** 1.19"	** 1.19"
		Spindle		72"	"A"	** 1.13"	** 1.13"	** 1.13"
		Hub	"D"	Gearbox	"D"	** 0.00"		
				Pump Pulley		Ref	Left Pump	Right Pump
						"C"	** 0.00"	** 0.00"
Tiger Cat (STCII) 48" & 52" Cutter Deck Belt Routing		Spindle Pulley Alignment		Deck Size	Ref	Right Spindle	Center Spindle	Left Spindle
		Hub	"A"	48"	A	**1.25"	-	**0.50"
		Pulley		52"	B	-	**0.50"	-
		Spindle			A	**1.20"	-	**0.50"
		Hub	"B"		B	-	-	-
				Pump Pulley		Ref	Left Pump	Right Pump
						"C"	** 0.125"	**0.125"
Tiger Cat (STCII) 61" Cutter Deck Belt Routing		Spindle Pulley Alignment		Deck Size	Ref	Right Spindle	Center Spindle	Left Spindle
		Hub	"A"	61"	"A"	**1.20"	-	**0.50"
		Pulley			"B"	-	**0.50"	-
		Spindle						
		Hub	"B"					
				Pump Pulley		Ref	Left Pump	Right Pump
						"C"	** 0.125"	** 0.125"
SCZ 48" & 52" Cutter Deck Belt Routing		Spindle Pulley Alignment		Deck Size	Ref	Right Spindle	Center Spindle	Left Spindle
		Hub	"A"	48"	"A"	**1.25"	-	**0.20"
		Pulley		52"	"B"	-	**0.50"	-
		Spindle			"A"	**1.20"	-	**0.50"
		Hub	"B"		"B"	-	-	-
				Pump Pulley		Ref	Left Pump	Right Pump
						"C"	**0"	**0"



Cutter Deck Belt Routing & Pulley Height Chart

** All measurements are from the end of the shaft to the top of the Tapered Hub or Pulley

All References for Left, Right or Center are from the Operator's position

SCZ, SCZII 61" & 72" Cutter Deck Belt Routing

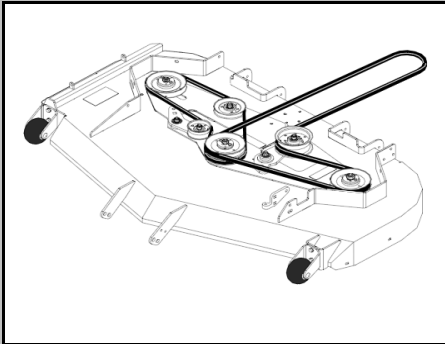

Spindle Pulley Alignment

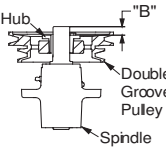
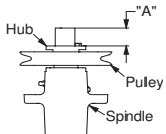

Deck Size	Ref	Right Spindle	Center Spindle	Left Spindle
61"	"A"	** 0.20"	-	.50"
72"	"B"	-	.25"	.50"
	"A"	1.20"	-	.50"
	"B"	-	.25"	-

Pump Pulley Ref Left Pump Right Pump

"C"	** 0.00"	** 0.00"
-----	----------	----------

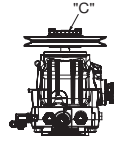

SPZ, SFZ, & SZL 48" or Larger Cutter Deck Belt Routing

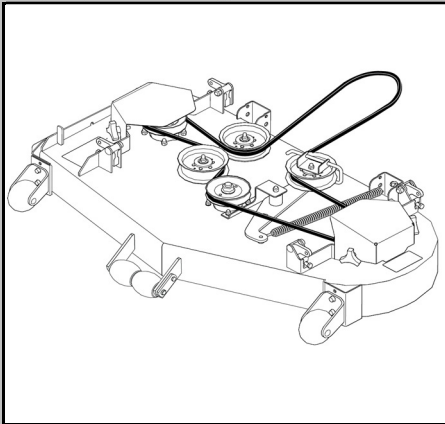

Spindle Pulley Alignment

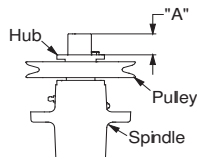

Deck Size	Ref	Right Spindle	Center Spindle	Left Spindle
48"	"A"	.85"	.85"	.85"
52"	"A"	.85"	.85"	.85"
61"	"A"	.85"	.85"	.85"

Pump Pulley Ref Left Pump Right Pump

"C"	** 0.00"	** 0.00"
-----	----------	----------

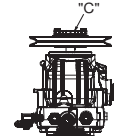

SZL 36" Cutter Deck Belt Routing

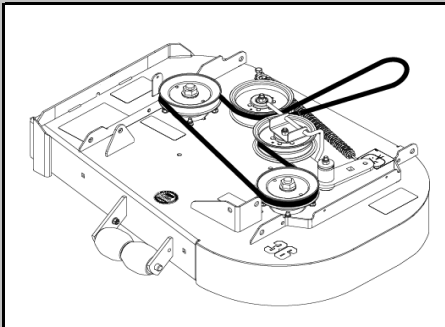

Spindle Pulley Alignment

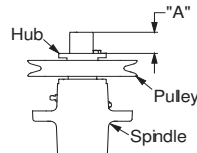

Deck Size	Ref	Right Spindle	Center Spindle	Left Spindle
36"	"A"	** 0.70"	-	** 0.50"

Pump Pulley Ref Left Pump Right Pump

"C"	** 0.00"	** 0.00"
-----	----------	----------

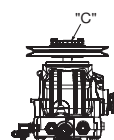

SVR, SVRII & SWZT 48" or Larger Cutter Deck Belt Routing

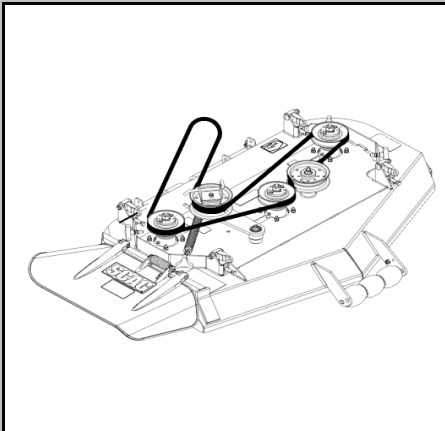

Spindle Pulley Alignment

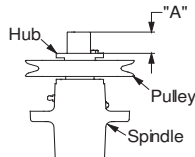

Deck Size	Ref	Right Spindle	Center Spindle	Left Spindle
48"	"A"	.125"	.125"	.125"
52"	"A"	.125"	.125"	.125"
61"	"A"	.125"	.125"	.125"

Pump Pulley Ref Left Pump Right Pump

"C"	** 0.00"	** 0.00"
-----	----------	----------

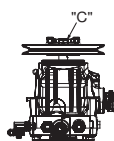



Cutter Deck Belt Routing & Pulley Height Chart

** All measurements are from the end of the shaft to the top of the Tapered Hub or Pulley

All References for Left, Right or Center are from the Operator's position

SVR, SVRII 32" & 36" Cutter Deck Belt Routing

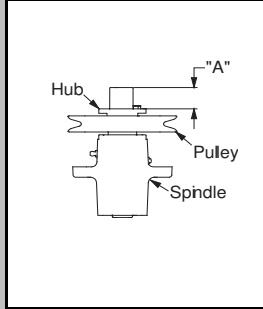
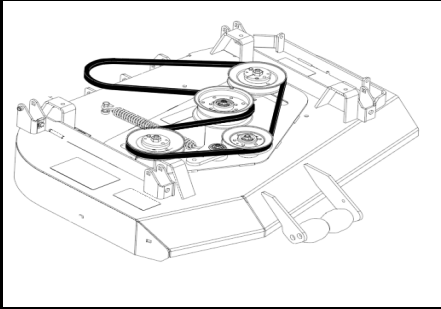

Deck Size	Ref	Right Spindle	Center Spindle	Left Spindle
32"	"A"	** 0.125"	-	** 0.125"
36"	"A"	** 0.125"	-	** 0.125"

Pump Pulley	Ref	Left Pump	Right Pump
"C"	"C"	** 0.00"	** 0.00"



SWZT, SW, & SWZ 36" Cutter Deck Belt Routing

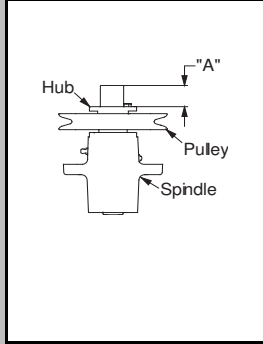
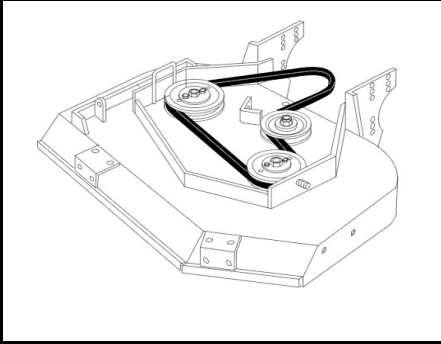

Deck Size	Ref	Right Spindle	Center Spindle	Left Spindle
36"	"A"	** 0.125"	-	** 0.125"

Pump Pulley	Ref	Left Pump	Right Pump
"C"	"C"	** 0.00"	** 0.00"

