



# L.T. Rich Products, Inc.

## 36" Slice Seeder Installation Instruction Sheet

Date: January 27th, 2011

Bulletin #: 007

Subject: Slice Seeder Installation Instruction Sheet

Model(s): All Z-Plug (3 wheeled and 4 wheeled units)

L T Rich Products has designed an instruction sheet to install and adjust the 36" Slice Seeder (designed for both the 3 wheeled Z-Plug units and the 4 wheeled Z-Plug units). This instruction sheet will assist you and/or your staff to install the Z-Plug Slice Seeder Attachment to your Z-Plug unit.

If at any time you have questions about the 36" Slice Seeder attachment installation, feel free to call us at **765-482-2040** or **877-482-2040**.

Remove any current mid-mount attachment that is currently on the unit (Aerator head, 18 gallon spray tank, De-Thatch Rake or Snow Blade). This can be done by removing the chain linkages, hydraulic ball swivel linkage, front pins and/or front ball swivel pins to remove all linkages to attachment(s). Drive unit to the left or to the right to move unit away from current attachment (*pictured below is the aerator head being removed from traction unit*)



Once the traction unit is free of any attachments (in the under carriage area), drive the aerator traction unit to the rear of the Slice Seeder attachment (*pictured below*). Position the rear wheel that is next to the Slice Seeder approximately to the middle of the rear stars. Turn the front of the unit to position the aerator traction unit over the Slice Seeder (*pictured below*) and turn off the engine.



[www.zspray.com](http://www.zspray.com)

920 Hendricks Drive Lebanon, IN 46052

(765) 482-2040 or (877) 482-2040

Fax (765) 482-2050





# L.T. Rich Products, Inc.

Unlock attachment lock plate to allow pull pin to rest on top of front attachment plate (*pictured below*). Lift the front of the Slice Seeder and position the pull pins into the attachment plate, re-lock plate and install lynch pins to secure (*pictured below*). Start the aerator and line up the ball swivel linkage to the rear uprights holes with the hydraulic lever (*pictured below*). Small adjustments to the ball swivel linkage may need to be made when attaching the Slice Seeder.



Your Slice Seeder is now attached to your Aerator. Before using, make sure that the knives are adjusted to your specifications as well as the drop rate gate is adjusted accordingly. To adjust the knives, remove the pin on the side of the Slice Seeder and set in the desired hole location (*pictured below*). Once you have adjusted the knives to your specifications, ensure that you're seed dispersal amount is correct. The front handle opens and closes the drop door on the Slice Seeder. The rate knob is located at the front of the Gandy Box and will need to be adjusted before opening the drop door with the handle (*drop door handle pictured below*).

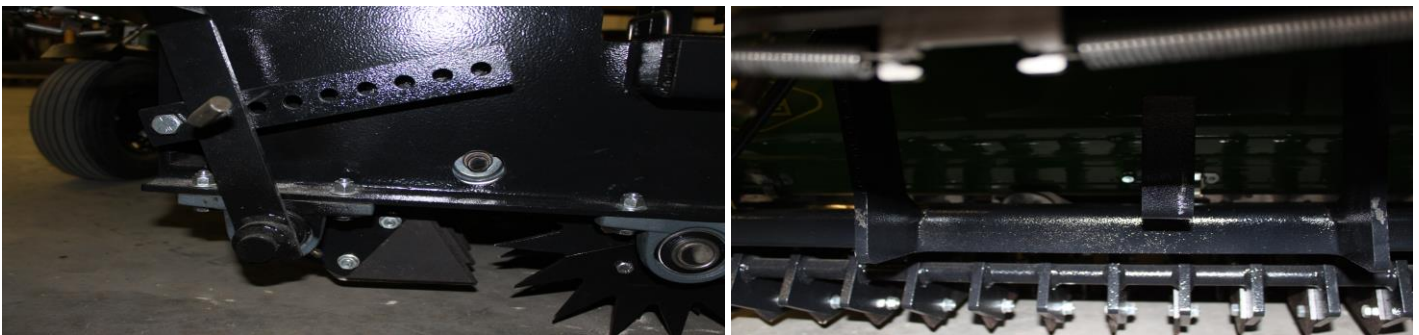

The feed impellers are ground driven by the rear stars. Make sure that the space between the stars are cleaned and do not have dirt/turf build up. Enough build up of debris will cause the stars to lose traction and not drop the desired seed amounts. Calibration chart is located on the rear panel of the slice seeder box for reference. Your Slice Seeder is now ready to operate.

**\* If you have questions about this update kit bulletin, please call us at L T Rich Products, Inc \***

[www.zspray.com](http://www.zspray.com)

920 Hendricks Drive Lebanon, IN 46052

(765) 482-2040 or (877) 482-2040

Fax (765) 482-2050





# L.T. Rich Products, Inc.

## L.T. Rich 36" Slit Seeder Calibration / Parts Breakdown

### Rate Chart:

This rate chart is for 36-inch Gandy Spreaders with snap-off stainless steel bottoms. The term "gauge settings" refers to the numbers stamped on the gauge of the adjustable, stainless steel bottom which comes as standard equipment. The term "bottom number" refers to the size designation of the various fixed rate bottoms available for 36-inch models.

These charts are a *starting point* for finding the gauge setting for your Gandy Spreader(s). Follow this procedure when using these charts:

#### 1. Determine the RATE.

Read the product label and determine the rate to be applied. 1 Acre = 43,560 Square Feet.

1 mph	1 ½ mph	2 mph	2 ½ mph	3 mph	3 ½ mph	4 mph	4 ½ mph	5 mph
88ft	132ft	176ft	220ft	264ft	308ft	352ft	396ft	440ft

#### 2. Check your GROUND SPEED.

Use these distance traveled in one minute:

Ground speed is an important factor in determining the application rate. For example, if you set your gauge for a rate based on 2 mph, but travel 1 mph, you will be applying twice the desired rate.

#### 3. Choose the GAUGE SETTING.

Turn to the chart for your product. Under your speed, find rate and read across the starting gauge setting. Set the gauge using the top of the stop as the gauge point. If your product is not in the rate chart, but has a setting for Scotts PF Drop Spreader, use the conversion chart below. Always remember the chart number is only a starting point to begin a calibration check.

#### 4. Check your RESULTS.

Manufacturers of chemicals, fertilizers and other materials may change their formulations without notice. Atmospheric conditions also can change the flow of some materials. Check your rate of application to be sure your formulation is the same as the one used in calibration. We recommend this procedure:

[www.zspray.com](http://www.zspray.com)

920 Hendricks Drive Lebanon, IN 46052

(765) 482-2040 or (877) 482-2040

Fax (765) 482-2050





# ***L.T. Rich Products, Inc.***

- A. Suspend a calibration pan under the hopper.
- B. Set gauge.
- C. Place a sufficient amount of material in the hopper for a practice area.
- D. Cover a known area, such as 1,000 sq. ft.
- E. Weigh the contents of the calibration pan.
- F. Divide the weight by the known area to determine rate applied. If necessary, adjust the gauge up or down and repeat.

## **\*\*CONVERSION CHART from O. M. Scott's PF Drop Spreader to Gandy Drop Spreader\*\***

Use this handy conversion chart for setting Gandy spreaders when only O.M. Scotts PF drop spreader gauge settings are given. However, always check your rate of application to be sure your formulation is the same as the one used in calibration. We recommend the procedure listed above. Atmospheric conditions alone can affect the flow of materials.

### **SCOTT'S GAUGE SETTING NUMBERS**

3.5	4.0	4.5	5.0	6.0	6.5	7.0	7.5	8.0	8.5	9.0	9.5	10.0	11.0	12.0
20.0	22.0	26.0	30.5	35.0	37.0	39.0	40.0	41.0	41.5	44.0	45.0	45.5	46.5	47.5

### **GANDY GAUGE SETTING NUMBERS**

**[www.zspray.com](http://www.zspray.com)**

920 Hendricks Drive Lebanon, IN 46052  
(765) 482-2040 or (877) 482-2040  
Fax (765) 482-2050





# L.T. Rich Products, Inc.

## Gandy Slit Seeder Box Parts Breakdown

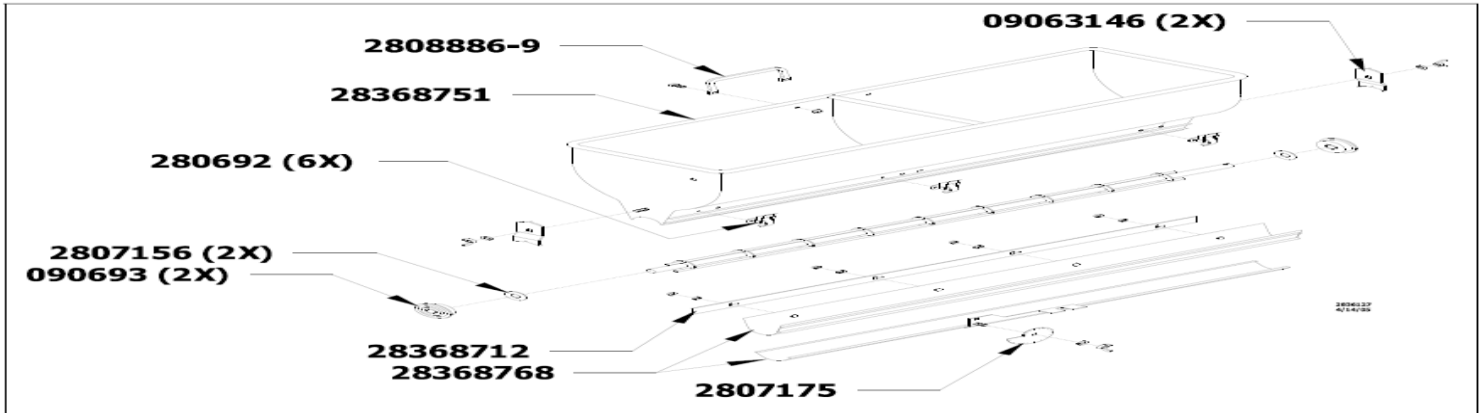

- 1.....28368751.....Hopper, 36 Inch
- 1.....28306854-1.....Retainer, End Bearing Left
- 1.....28306854-2.....Retainer, End Bearing Right
- 2.....090693.....End Bearing
- 1.....70507.....Seed Agitator Bar / Rotor Bar
- 2.....2807156.....Washer (in place)
- 1.....70506.....Bottom & Slide (in place)
- 1.....28368712.....Bottom & Slide Mount Plate
- 1.....2807175.....Rate Dial Plate

## L.T. Rich Slit Seeder Parts Breakdown

- 15.....80725-B.....4" Slicing Knife
- 2.....80704.....7/8 X 4 1/2 Lift Pin
- 4.....80709.....Pillow Block Bearings
- 4.....80703-B.....A-50 Collars
- 30.....HHCS5-381.....3/8-16 X 1 Hex Cap Grade 5
- 64.....HNML8-516C.....5/16-18 Locknut
- 64.....HHCS5-5161.....5/16-18 Hex Head Cap
- 12.....NNC-38.....3/8-16 Nylon Nut Zinc
- 12.....HHCS5-38112.....3/8-16 X 1 1/2 Hex Head Cap
- 24.....FW-SAE-38.....3/8 SAE Flat Washer
- 30.....HFNC5-38S.....3/8-16 Hex Flange Lock Nut
- 32.....80636.....Aerator Slit Seeder Star
- 1.....70502.....Slit Seeder Upper Sprocket
- 1.....70503.....Slit Seeder Lower Sprocket
- 2 ft.....70504.....Slit Seeder Chain
- 1.....70505.....Slit Seeder Master Link

[www.zspray.com](http://www.zspray.com)

920 Hendricks Drive Lebanon, IN 46052

(765) 482-2040 or (877) 482-2040

Fax (765) 482-2050





# L.T. Rich Products, Inc.

SLICE SEEDER Parts List - 80681-A		
ITEM	QTY	PART NUMBER
1	1	70501
2	4	70501-S
3	4	80709
4	1	80641-B-W
5	1	80734
6	1	80643-W
7	15	80725-B
8	2	80704-B
9	1	80681-W
10	1	80642 - W
11	2	SS10001
12	32	80636
13	1	AE20065-W
14	1	70503
15	1*	70504/70504-CHAIN
16	1	70502
17	1	70501-7
18	2	81002
19	1	80645Rev1 - W

\*20 LINKS + 1 LINK + 1 MASTER

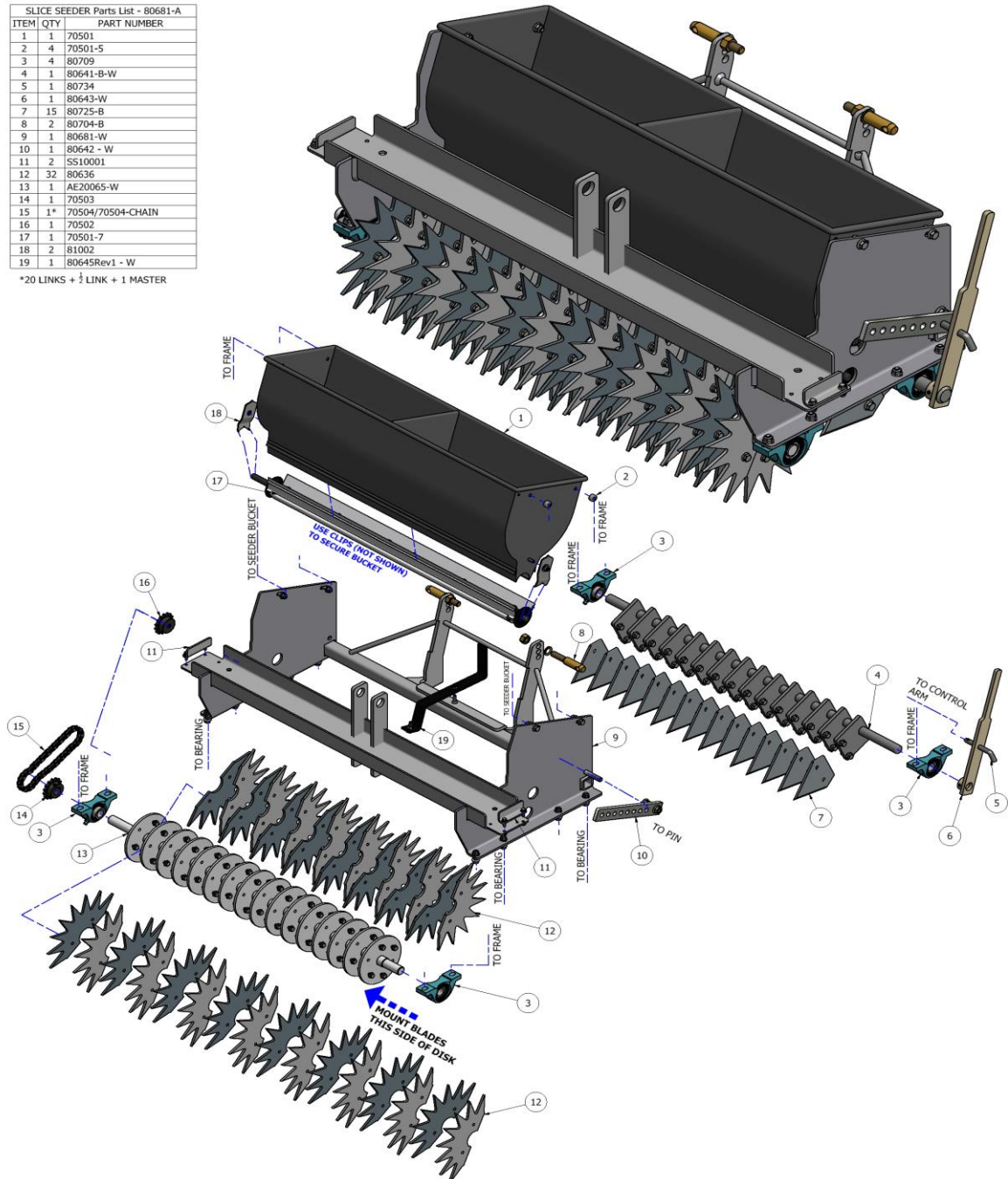

[www.zspray.com](http://www.zspray.com)

920 Hendricks Drive Lebanon, IN 46052  
 (765) 482-2040 or (877) 482-2040  
 Fax (765) 482-2050

